

Automotive Data Solutions Inc.

INSTALL GUIDE

ADVANCED MENUS V2

AVAILABLE FOR:

VERSION FRANÇAISE DISPONIBLE EN LIGNE AU WWW.IDATALINK.COM
PLEASE VISIT WWW.IDATALINK.COM/SUPPORT FOR COMPLETE PRODUCT DETAILS

The brand names and logos found in this guide are property of their respective owners. Automotive Data Solutions Inc. © 2012

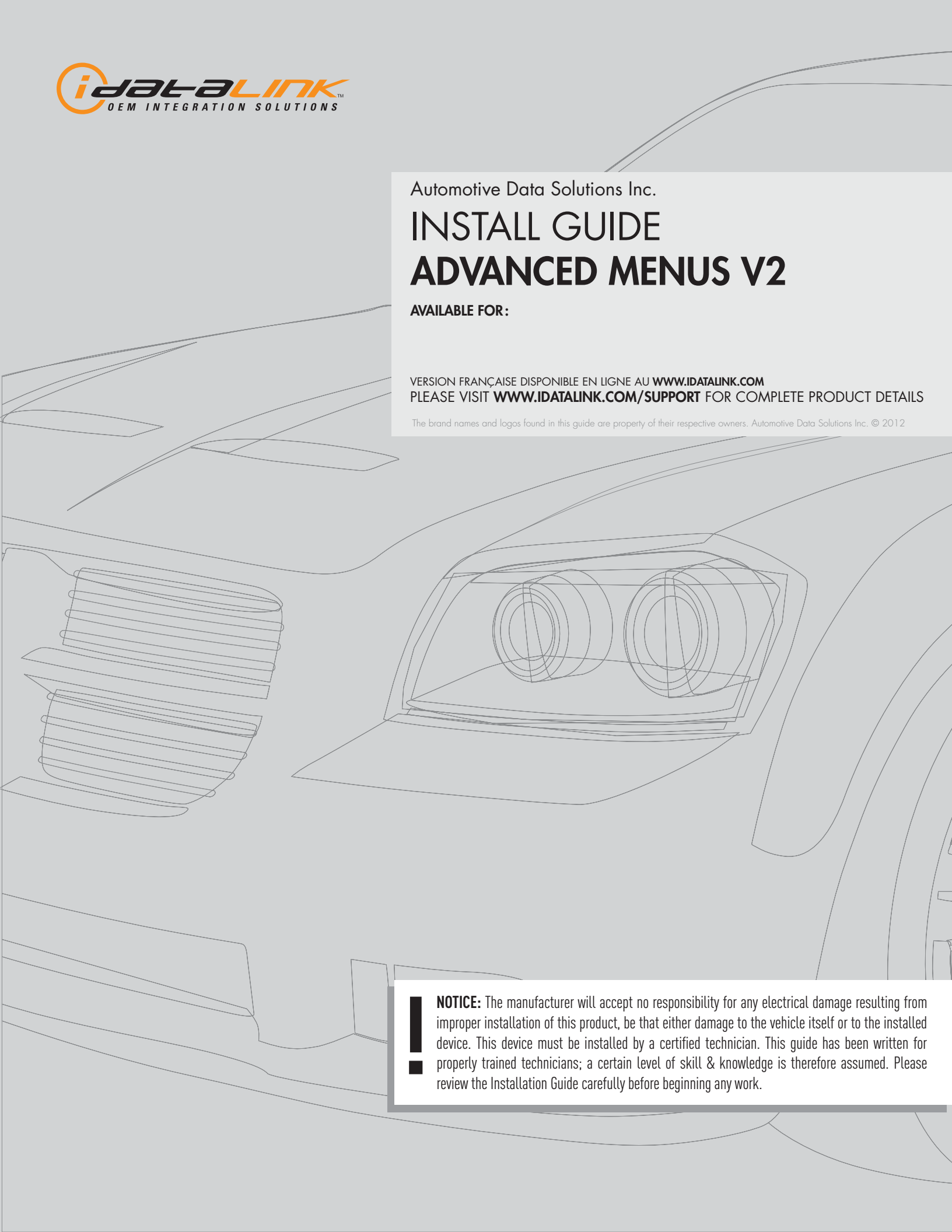

NOTICE: The manufacturer will accept no responsibility for any electrical damage resulting from improper installation of this product, be that either damage to the vehicle itself or to the installed device. This device must be installed by a certified technician. This guide has been written for properly trained technicians; a certain level of skill & knowledge is therefore assumed. Please review the Installation Guide carefully before beginning any work.

MODULE NAVIGATION PROCEDURE - 1 OF 2 - FOLLOW STEPS 1 TO 3 FOR EACH MENU

STEP 1 - MENUS 1, 2, 3, 4, 5 & 6*

NOTE

- I It is mandatory to exit the Module Navigation at the end of this procedure. Failure to exit the Module Navigation will drain vehicle battery.
- II Module must be programmed to the vehicle.
- III Remove key from ignition.



To exit the Module Navigation at any time:
Follow STEP 3.

1

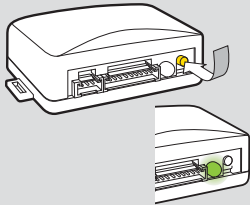

To access the **MENUS**:

Press and hold programming button until LED turns solid GREEN.

Release programming button.

2

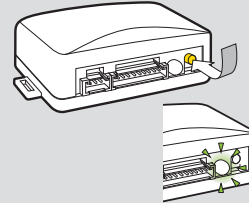

In the **MENUS**:

Press the programming button as many times as the menu number indicates.

LED will flash GREEN an equal amount of times continuously.

3

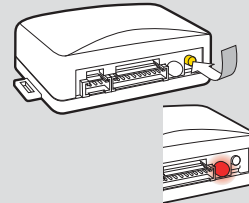

(*Not applicable for menu 6)

To access the **OPTIONS**:

Press and hold programming button until LED turns solid RED.

Release programming button.

4

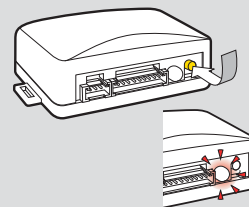

(*Not applicable for menu 6)

In the **OPTIONS**:

Press the programming button as many times as the option number indicates.

LED will flash RED an equal amount of times continuously.

STEP 2 - MENUS 1, 2 & 3

1

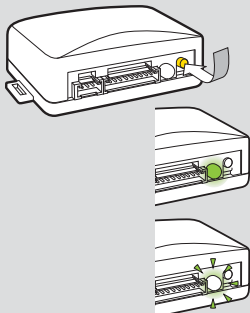

To access the **SETTINGS**:

Press and hold programming button until LED turns solid GREEN.

Release programming button.

LED will flash GREEN as many times as the current (or default) setting number, continuously.

2

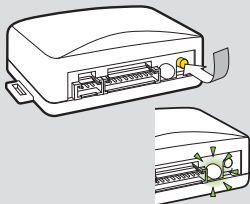

In the **SETTINGS**:

Press the programming button as many times as necessary to access your setting.

LED will flash GREEN an equal amount of times continuously.

3

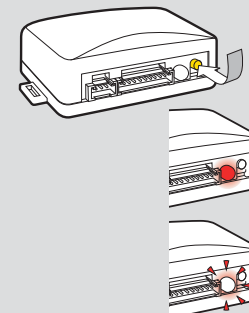

To save and return to the **OPTIONS**:

Press and hold programming button until LED turns solid RED.

Release programming button.

LED will flash RED as many times as the current option number continuously.

Configure every other setting and proceed to STEP 4.

MODULE NAVIGATION PROCEDURE - 2 OF 2 - FOLLOW STEPS 1 TO 3 FOR EACH MENU

STEP 2 - MENU 4

1

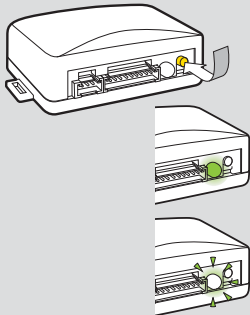

To access the **READINGS**:

Press and hold programming button until LED turns solid GREEN.

Release programming button.

LED will turn ON [1] or OFF [0] to indicate the current reading number.

STEP 2 - MENU 5

1

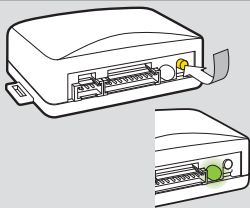

To access the **TESTS**:

Press and hold programming button until LED turns solid GREEN.

Release programming button.

2

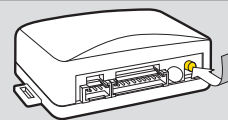

In the **TESTS**:

Press the programming button once [1x] to send the command. (Repeat as many times as necessary)

STEP 2 - MENU 6

1

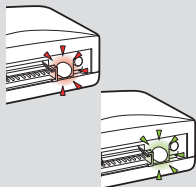

LED will flash RED once [1x] to indicate the first option then LED will flash GREEN as many times as the current summary number.

2

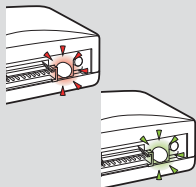

LED will flash RED twice [2x] to indicate the second option then LED will flash GREEN as many times as the current summary number.

3

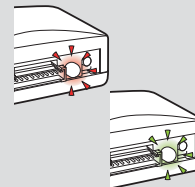

LED will flash RED three times [3x] to indicate the third option then LED will flash GREEN as many times as the current summary number.

STEP 3 - MENUS 1, 2, 3, 4, 5 & 6



To return to the **MENUS**: exit the Module Navigation and redo the Module Navigation Procedure.

2

Module navigation completed.



Failure to exit the Module Navigation will drain vehicle battery.

1

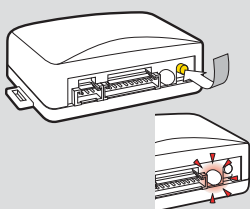

MANDATORY:
EXIT MODULE NAVIGATION

Press and hold programming button for 7 seconds.

LED will flash RED rapidly.

Release programming button.

LED will turn OFF.

MENU 1, 2 & 3 - MODULE NAVIGATION PROCEDURE

NOTE

- I It is mandatory to exit the Module Navigation at the end of this procedure. Failure to exit the Module Navigation will drain vehicle battery.
- II Module must be programmed to the vehicle.
- III Remove key from ignition.



To exit the Module Navigation at any time:
Follow step 8.

1

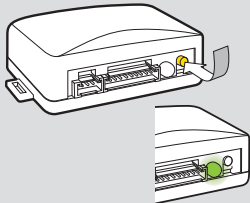

To access the **MENUS**:

Press and hold programming button until LED turns solid GREEN.

Release programming button.

2

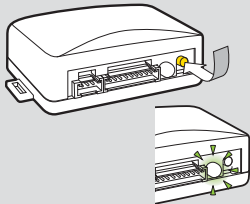

In the **MENUS**:

Press the programming button as many times as the menu number indicates.

LED will flash GREEN an equal amount of times continuously.

3

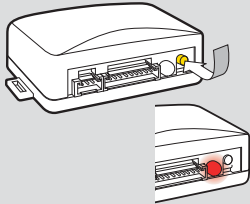

To access the **OPTIONS**:

Press and hold programming button until LED turns solid RED.

Release programming button.

4

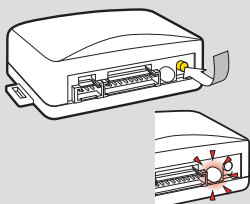

In the **OPTIONS**:

Press the programming button as many times as the option number indicates.

LED will flash RED an equal amount of times continuously.

5

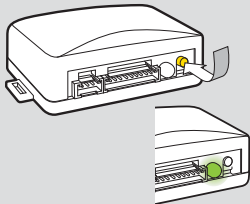

To access the **SETTINGS**:

Press and hold programming button until LED turns solid GREEN.

Release programming button.

LED will flash GREEN as many times as the current (or default) setting number, continuously.

6

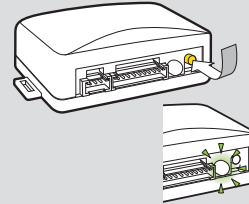

In the **SETTINGS**:

Press the programming button as many times as necessary to access your setting.

LED will flash GREEN an equal amount of times continuously.



To return to the **MENUS**: exit the Module Navigation and redo the Module Navigation Procedure.

7

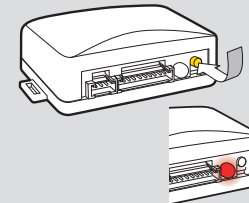

To save and return to the **OPTIONS**:

Press and hold programming button until LED turns solid RED.

Release programming button.

LED will flash RED as many times as the current option number continuously.

Configure every other setting and proceed to step 8.

8

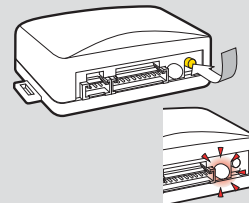

MANDATORY:
EXIT MODULE NAVIGATION

Press and hold programming button for 7 seconds.

LED will flash RED rapidly.

Release programming button.

LED will turn OFF.

9

Module navigation completed.



Failure to exit the Module Navigation will drain vehicle battery.

MENU 4 - MODULE NAVIGATION PROCEDURE

NOTE

- I It is mandatory to exit the Module Navigation at the end of this procedure. Failure to exit the Module Navigation will drain vehicle battery.
- II Module must be programmed to the vehicle.
- III Remove key from ignition.



To exit the Module Navigation at any time:
Follow step 6.

1

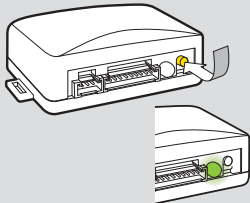

To access the **MENUS**:

Press and hold programming button until LED turns solid GREEN.

Release programming button.

2

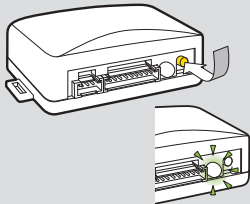

In the **MENUS**:

Press the programming button as many times as the menu number indicates.

LED will flash GREEN an equal amount of times continuously.

3

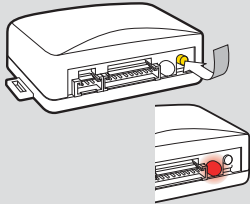

To access the **OPTIONS**:

Press and hold programming button until LED turns solid RED.

Release programming button.

4

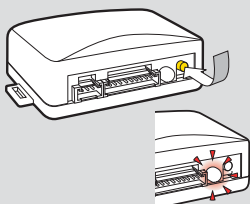

In the **OPTIONS**:

Press the programming button as many times as the option number indicates.

LED will flash RED an equal amount of times continuously.

5

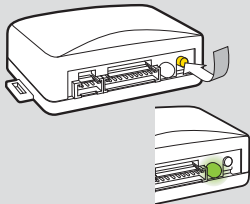

To access the **READINGS**:

Press and hold programming button until LED turns solid GREEN.

Release programming button.

LED will turn ON [1] or OFF [0] to indicate the current reading number.



To return to the **MENUS**: exit the Module Navigation and redo the Module Navigation Procedure.

6

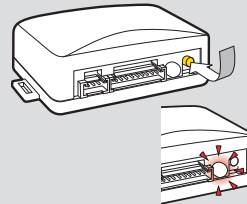

MANDATORY: EXIT MODULE NAVIGATION

Press and hold programming button for 7 seconds.

LED will flash RED rapidly.

Release programming button.

LED will turn OFF.

7

Module navigation completed.



Failure to exit the Module Navigation will drain vehicle battery.

MENU 5 - MODULE NAVIGATION PROCEDURE

NOTE

- I It is mandatory to exit the Module Navigation at the end of this procedure. Failure to exit the Module Navigation will drain vehicle battery.
- II Module must be programmed to the vehicle.
- III Remove key from ignition.



To exit the Module Navigation at any time:
Follow step 7.

1

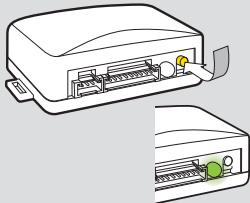

To access the **MENUS**:

Press and hold programming button until LED turns solid GREEN.

Release programming button.

2

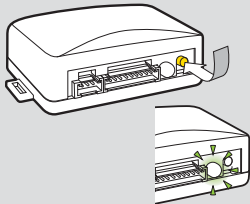

In the **MENUS**:

Press the programming button as many times as the menu number indicates.

LED will flash GREEN an equal amount of times continuously.

3

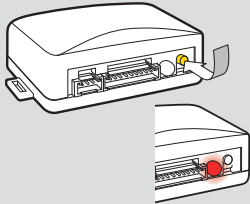

To access the **OPTIONS**:

Press and hold programming button until LED turns solid RED.

Release programming button.

4

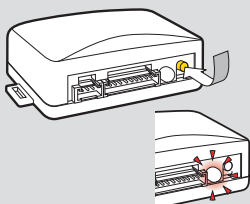

In the **OPTIONS**:

Press the programming button as many times as the option number indicates.

LED will flash RED an equal amount of times continuously.

5

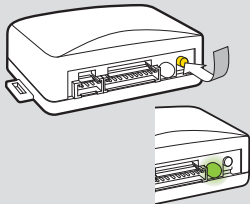

To access the **TESTS**:

Press and hold programming button until LED turns solid GREEN.

Release programming button.

6

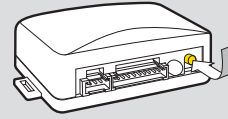

In the **TESTS**:

Press the programming button once [1x] to send the command. (Repeat as many times as necessary)



To return to the **MENUS**: exit the Module Navigation and redo the Module Navigation Procedure.

7

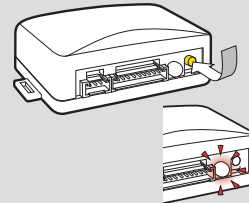

MANDATORY:
EXIT MODULE NAVIGATION

Press and hold programming button for 7 seconds.

LED will flash RED rapidly.

Release programming button.

LED will turn OFF.

8

Module navigation completed.



Failure to exit the Module Navigation will drain vehicle battery.

MENU 6 - MODULE NAVIGATION PROCEDURE

NOTE

- I It is mandatory to exit the Module Navigation at the end of this procedure. Failure to exit the Module Navigation will drain vehicle battery.
- II Module must be programmed to the vehicle.
- III Remove key from ignition.



To exit the Module Navigation at any time:
Follow step 8.

1

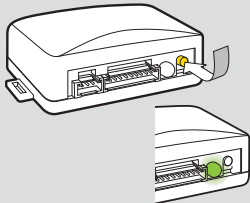

To access the **MENUS**:

Press and hold programming button until LED turns solid GREEN.

Release programming button.

2

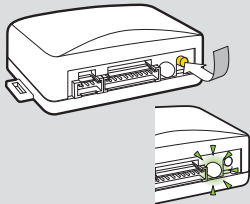

In the **MENUS**:

Press the programming button as many times as the menu number indicates.

LED will flash GREEN an equal amount of times continuously.

3

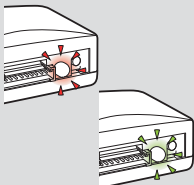

LED will flash RED once [1x] to indicate the first option then LED will flash GREEN as many times as the current summary number.

4

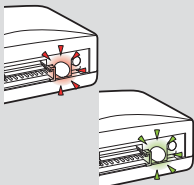

LED will flash RED twice [2x] to indicate the second option then LED will flash GREEN as many times as the current summary number.

5

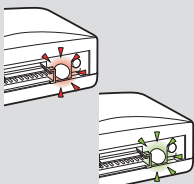

LED will flash RED three times [3x] to indicate the third option then LED will flash GREEN as many times as the current summary number.



To return to the **MENUS**: exit the Module Navigation and redo the Module Navigation Procedure.

8

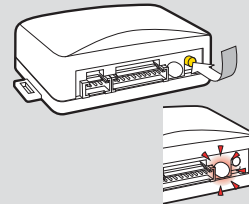

MANDATORY: EXIT MODULE NAVIGATION

Press and hold programming button for 7 seconds.

LED will flash RED rapidly.

Release programming button.

LED will turn OFF.

9

Module navigation completed.



Failure to exit the Module Navigation will drain vehicle battery.

MENU 1 - CONFIGURATION - DATA & HARDWARE

OVERVIEW

I Set, change and adjust features.

NOTE

- I Default settings are listed in bold.
- II Make sure the option is covered on the vehicle before attempting to change the setting.
- * Vehicle will shutdown when a door is opened.

APPLICATION

- AL(DL)
- AL(RS)
- DL
- BLADE-AL(DL)

| MENU | OPTIONS | SETTINGS |
|-----------------------------|-----------------------------------|------------------------------|
| 1 CONFIGURATION | 1 DISARM/UNLOCK BEFORE START | 1 OFF 2 ON |
| | 2 RELOCK AFTER START | 1 OFF 2 ON |
| | 3 RELOCK AFTER SHUTDOWN | 1 OFF 2 ON |
| | 4 FORCE UNLOCK ALL ON FIRST PRESS | 1 OFF 2 ON |
| | 5 TAKEOVER* | 1 ENABLE 2 DISABLE |
| | 6 SECURE TAKE OVER DELAY | 1 45 SEC |
| | | 2 90 SEC |
| | | 3 03 MIN |
| | | 4 04 MIN |
| | 7 FACTORY KEYLESS RS SEQUENCE | 1 DISABLE |
| | | 2 HOLD LOCK 3 SEC |
| | | 3 LOCK + UNLOCK + LOCK |
| 4 LOCK + LOCK + LOCK | | |
| 8 MODULE RUN TIME | 1 03 MIN | |
| | 2 05 MIN | |
| | 3 10 MIN | |
| | 4 15 MIN | |
| | 5 25 MIN | |
| | 6 30 MIN | |
| | 7 35 MIN | |
| 9 WAIT TO START DELAY | 1 02 SEC | |
| | 2 05 SEC | |
| | 3 08 SEC | |
| | 4 10 SEC | |
| | 5 15 SEC | |
| | 6 20 SEC | |
| | 7 25 SEC | |
| | 8 30 SEC | |
| 10 HEATED SEATS CONTROL | 1 OFF/MANUAL INPUT TRIGGER | |
| | 2 ALWAYS ON | |
| | 3 -10C/+14F | |
| | 4 -05C/+24F | |
| | 5 +00C/+32F | |
| | 6 +04C/+40F | |
| | 7 +08C/+46F | |
| | 8 +12C/+54F | |
| 11 REAR DEFOGGER CONTROL | 1 OFF/MANUAL INPUT TRIGGER | |
| | 2 ALWAYS ON | |
| | 3 -10C/+14F | |
| | 4 -05C/+24F | |
| | 5 +00C/+32F | |
| | 6 +04C/+40F | |
| | 7 +08C/+46F | |
| | 8 +12C/+54F | |
| 12 COOLED SEATS CONTROL | 1 OFF/MANUAL INPUT TRIGGER | |
| | 2 ALWAYS ON | |
| | 3 +20C/+68F | |
| | 4 +24C/+76F | |
| | 5 +28C/+82F | |
| | 6 +32C/+90F | |
| | 7 +36C/+96F | |

MENU 2 - COMMANDS ACCEPTED FROM THE RS - DATA & HARDWARE

OVERVIEW

- I Void a specific data command and allow a specific hardware command.

NOTE

- I Default settings are listed in bold.
- II Make sure the option is covered on the vehicle before attempting to change the setting.

APPLICATION

- * -AL(DL)
- * -DL
- ** -BLADE-AL(DL)

| MENU | OPTIONS | SETTINGS |
|-------------------------------------|-------------------------------------|----------------------|
| 2 | 1 DISARM | 1 DISABLED |
| | | 2 ENABLED |
| | 2 UNLOCK DRIVER DOOR | 1 DISABLED |
| | | 2 ENABLED |
| | 3 UNLOCK OTHER DOORS | 1 DISABLED |
| | | 2 ENABLED |
| | 4 LOCK | 1 DISABLED |
| | | 2 ENABLED |
| | 5 ARM | 1 DISABLED |
| | | 2 ENABLED |
| | 6 TRUNK RELEASE | 1 ANALOG*/DISABLED** |
| 2 ANALOG&DATA*/ENABLED** | | |
| 7 HORN | 1 ANALOG*/DISABLED** | |
| | 2 ANALOG&DATA*/ENABLED** | |
| 8 LEFT SLIDING DOOR | 1 ANALOG*/DISABLED** | |
| | 2 ANALOG&DATA*/ENABLED** | |
| 9 RIGHT SLIDING DOOR | 1 ANALOG*/DISABLED** | |
| | 2 ANALOG&DATA*/ENABLED** | |
| 10 PARK LIGHTS | 1 ANALOG*/DISABLED** | |
| | 2 ANALOG&DATA*/ENABLED** | |
| 11 STARTER | 1 ANALOG*/DISABLED** | |
| | 2 ANALOG&DATA*/ENABLED** | |

MENU 3 - STATUS REPORTED BY THE MODULE TO THE RS - DATA ONLY

OVERVIEW

- I Void a data status sent from the module to the RS and keep the hardware output enabled.

NOTE

- I Default settings are listed in bold.
- II Make sure the option is covered on the vehicle before attempting to change the setting.

APPLICATION

- AL(DL)
- DL
- BLADE-AL(DL)

| MENU | OPTIONS | SETTINGS |
|---------------------|------------------|------------------|
| 3 | 1 DOOR STATUS | 1 DISABLED |
| | | 2 ENABLED |
| | 2 TRUNK STATUS | 1 DISABLED |
| | | 2 ENABLED |
| | 3 HOOD STATUS | 1 DISABLED |
| | | 2 ENABLED |
| | 4 E-BRAKE STATUS | 1 DISABLED |
| | | 2 ENABLED |
| | 5 BRAKE STATUS | 1 DISABLED |
| 2 ENABLED | | |
| 6 TACHOMETER | 1 DISABLED | |
| | 2 ENABLED | |
| 7 VSS | 1 DISABLED | |
| | 2 ENABLED | |
| 8 GLOWPLUG STATUS | 1 DISABLED | |
| | 2 ENABLED | |
| 9 OEM REMOTE STATUS | 1 DISABLED | |
| | 2 ENABLED | |

MENU 4 - DISPLAY VEHICLE STATUS ON LED - DATA ONLY

OVERVIEW

- I Troubleshoot every status individually.

NOTE

- I Make sure the option is covered on the vehicle before attempting to change the setting.

APPLICATION

- AL(DL)
- AL(RS)
- DL
- BLADE-AL(DL)

| MENU | OPTIONS | READINGS |
|----------------------|---------------------------|----------|
| 4 | 1 DRIVER DOOR STATUS | 0 OFF |
| | | 1 ON |
| | 2 OTHER DOORS STATUS | 0 OFF |
| | | 1 ON |
| | 3 TRUNK STATUS | 0 OFF |
| | | 1 ON |
| | 4 HOOD STATUS | 0 OFF |
| | | 1 ON |
| | 5 E-BRAKE STATUS | 0 OFF |
| | | 1 ON |
| 6 BRAKE STATUS | 0 OFF | |
| | 1 ON | |
| 7 TACHOMETER STATUS | 0 OFF | |
| | 1 ON | |
| 8 VSS STATUS | 0 OFF | |
| | 1 ON | |
| 9 GLOW PLUG STATUS | 0 OFF | |
| | 1 ON | |
| 10 OEM REMOTE STATUS | 0 OFF | |
| | 1 GREEN or BLUE: LOCK/ARM | |
| | 1 RED: UNLOCK/DISARM | |

MENU 5 - OUTPUTS TEST - DATA ONLY (DBI NOT COVERED)

OVERVIEW

- I Send a supported data command to the vehicle with the module.

NOTE

- I Make sure the option is covered on the vehicle before attempting to change the setting.

APPLICATION

- AL(DL)
- AL(RS)
- DL
- BLADE-AL(DL)

| MENU | OPTIONS | TESTS |
|------|----------------------|----------------|
| 5 | 1 DISARM | 1 SEND COMMAND |
| | 2 UNLOCK DRIVER DOOR | 1 SEND COMMAND |
| | 3 UNLOCK ALL DOORS | 1 SEND COMMAND |
| | 4 LOCK | 1 SEND COMMAND |
| | 5 ARM | 1 SEND COMMAND |
| | 6 TRUNK RELEASE | 1 SEND COMMAND |
| | 7 HORN* | 1 SEND COMMAND |
| | 8 LEFT SLIDING DOOR | 1 SEND COMMAND |
| | 9 RIGHT SLIDING DOOR | 1 SEND COMMAND |
| | 10 PARKING LIGHTS | 1 SEND COMMAND |

MENU 6 - INSTALLATION INFORMATION - DATA & HARDWARE

OVERVIEW

I Get a detailed installation summary.

APPLICATION

- AL(DL)
- AL(RS)
- DL
- BLADE-AL(DL)

| MENU | OPTIONS | SUMMARY |
|------|----------------------------|---------------------------|
| 6 | 1 PROGRAMMING MENU VERSION | 1 V2.0 |
| | | 2 V2.1 |
| | | 3 V2.2 |
| | 2 INSTALLATION METHOD | 1 ANALOG |
| | | 2 IDATALINK 1 WAY |
| | | 3 IDATALINK |
| | | 4 ENCRYPTR 2 WAY |
| | | 5 DBI 2 WAY |
| | | 6 RF-DBI |
| | | 7 RF IDATALINK 2WAY |
| | 3 LAST ERROR CODE | 1 NO ERROR |
| | | 2 VALET MODE |
| | | 3 HOOD OPEN (DATA) |
| | | 4 HOOD OPEN (ANALOG) |
| | | 5 BRAKE |
| | | 6 TACH LOST |
| | | 7 TACH OVER REV (3500RPM) |
| | | 8 DOOR OPEN |

SUPPORTED FIRMWARE CHART - REVISION 09/22/11

| FIRMWARE | SUPPORTED | VERSION |
|----------|-----------|---------|
| DL-CH4 | YES | V2.31 |
| DL-CH5 | YES | V2.61 |
| DL-CH6 | NO | N/A |
| DL-CH7 | YES | V1.01 |
| DL-FM | NO | N/A |
| DL-GM1 | YES | V4.61 |
| DL-GM2 | NO | N/A |
| DL-GM3 | NO | N/A |
| DL-GM4 | NO | N/A |
| DL-GM5 | NO | N/A |
| DL-GM6 | NO | N/A |
| DL-GM7 | YES | V1.51* |
| DL-GM8 | NO | N/A |
| DL-GM9 | YES | V1.01 |
| DL-HA | NO | N/A |
| DL-HK | NO | N/A |
| DL-HK2 | NO | N/A |
| DL-HK3 | NO | N/A |
| DL-MA | YES | V1.51 |
| DL-MI2 | YES | V1.51 |
| DL-NI | NO | N/A** |
| DL-NI1 | YES | V1.12 |
| DL-NI2 | YES | V1.41 |
| DL-NI3 | YES | V1.61 |
| DL-SUB | YES | V2.0 |
| DL-TL1 | YES | V2.11 |
| DL-TL2 | YES | V1.92 |
| DL-TL3 | YES | V1.62 |
| DL-TL4 | YES | V1.01 |
| DL-V0 | NO | N/A |
| DL-V01 | YES | V1.01 |
| DL-V02 | YES | V1.01 |
| DL-V03 | YES | V1.01 |
| DL-VW | NO | N/A*** |
| DL-VW1 | YES | V1.21 |
| DL-VW2 | NO | N/A |
| DL-VW3 | YES | V1.11 |
| DL-VW4 | YES | V1.21 |
| DL-VW5 | YES | V1.01 |

| FIRMWARE | SUPPORTED | VERSION |
|----------|-----------|---------|
| RS-CH4 | YES | V1.11 |
| RS-CH5 | YES | V1.11 |
| RS-TL1 | YES | V1.01 |
| RS-TL2 | YES | V1.01 |
| RS-TL3 | YES | V1.01 |
| RS-HK2 | YES | V1.01 |
| TB-CH6 | NO | N/A |
| TB-FM | NO | N/A |
| TB-FM2 | YES | V3.11 |
| TB-FM3 | YES | V1.31 |
| TB-FM4 | NO | N/A |
| TB-GD | YES | V2.61 |
| TB-GM1 | YES | V1.01 |
| TB-GM2 | YES | V1.01 |
| TB-GM3 | YES | V1.01 |
| TB-HA | NO | N/A |
| TB-HA1 | NO | N/A |
| TB-HK | NO | N/A |
| TB-HK2 | NO | N/A |
| TB-PK1 | YES | V1.01 |
| TB-PL | NO | N/A |
| TB-PL1 | YES | V1.01 |
| TB-PL2 | YES | V1.01 |
| TB-PR | NO | N/A |
| TB-SUB | YES | V1.21 |
| TB-TL | NO | N/A |
| TB-TL2 | NO | N/A |

*EXCLUDE ALCA-32 ENC AND BLADE-32K

**DEPRECATED, USE NI1, NI2 OR NI3

***DEPRECATED, USE VW1, VW2 OR VW3